



P.U.A. - "FOGAZZARO"
via Antonio Fogazzaro



Progettisti: Arch. LISSANDRON LORIS TULLIO

Timbro e firma

Committente: IMMOBILIARE MOGLIANO s.n.c. di SAVIO L. & C. Via Pertini, 18 - 30173 Mestre (VE)

Timbro e firma

RILIEVO EDIFICI ESISTENTI
DIMOSTRAZIONE SUPERFICIE REALE

Scala: 1:500
1:1000

elaborato n.:

03

LORIS TULLIO LISSANDRON
ARCHITETTO
Via Cà Pisani n. 4, Vigodarzere (PD)
Tel. 049.8871818; Cell.347.4684136
E-Mail: arch.lorisliissandron@gmail.com
PEC: arch.lorisliissandron@pec.it

Data: giugno 2023
aggiornamenti:



Questo documento non potrà essere riprodotto, copiato o altrimenti pubblicato (in tutto o in parte) senza il consenso del progettista - L.22/04/11 n.83



TABELLE CALCOLO SUPERFICI E VOLUMI

FABBRICATI DA DEMOLIRE			
DATI TECNICI			
CORPO DI FABBRICA	SUPERFICIE COPERTA	ALTEZZA	VOLUME
"A"	577,60 723,80	6,25 12,00	3610,00 8685,60
"B"	474,98 52,14	4,00 4,20	1899,92 218,99
"C"	149,43	3,40	508,06
"D"	838,00 40,80	6,84 6,40	5731,92 261,12
TOTALE	2.856,75		20.915,01

FABBRICATI RIMANENTI			
DATI TECNICI			
CORPO DI FABBRICA	SUPERFICIE COPERTA	ALTEZZA	VOLUME
"E"	25,20	3,00	75,60
DEMOLIZIONI	2.856,75		20.915,01
COMPLESSIVO	2.881,95		20.991,21

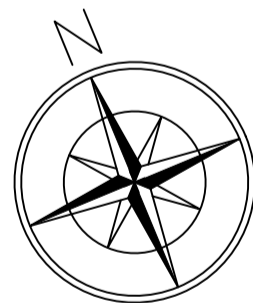
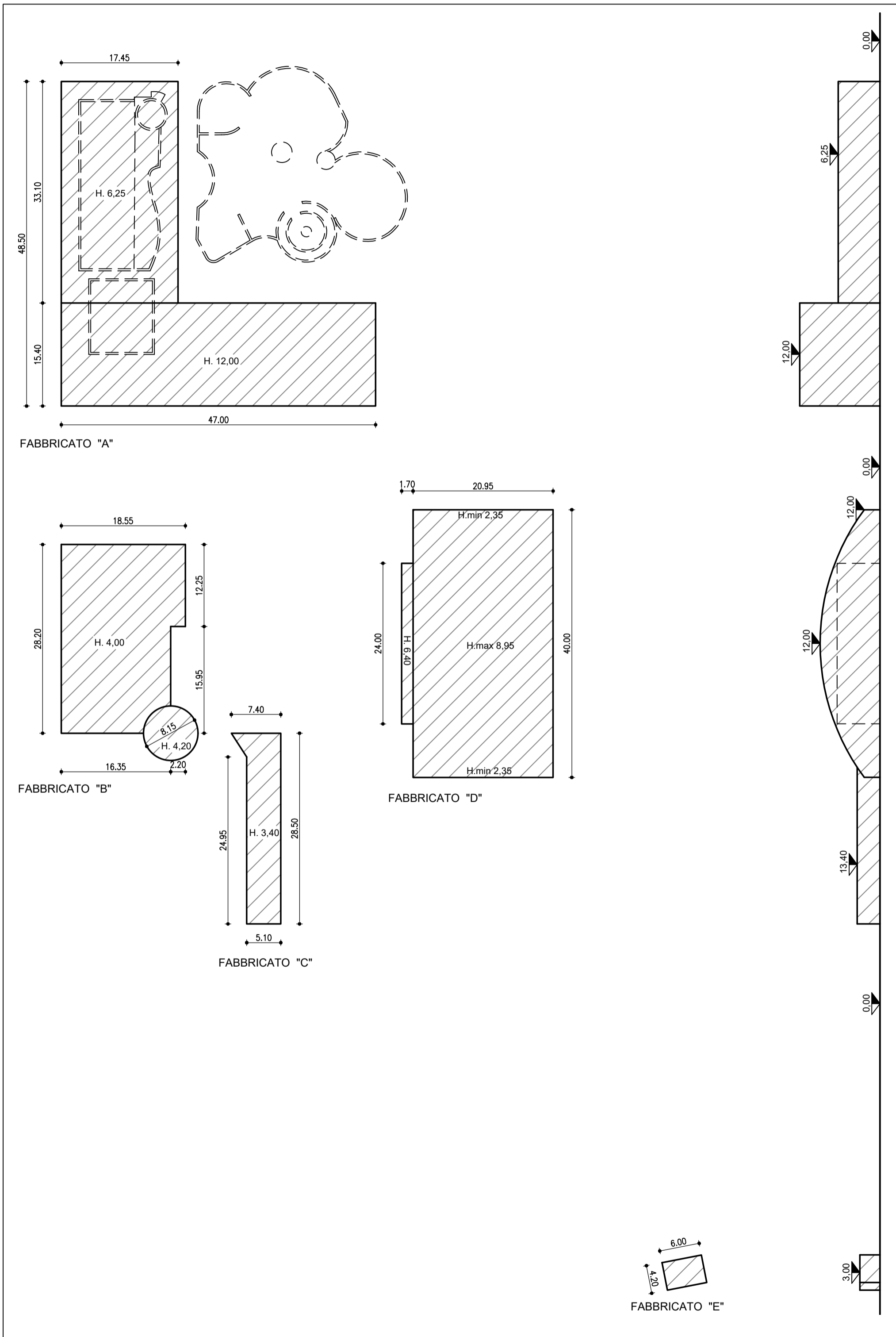

PIANTA E PROFILO EDIFICI ESISTENTI scala 1:500

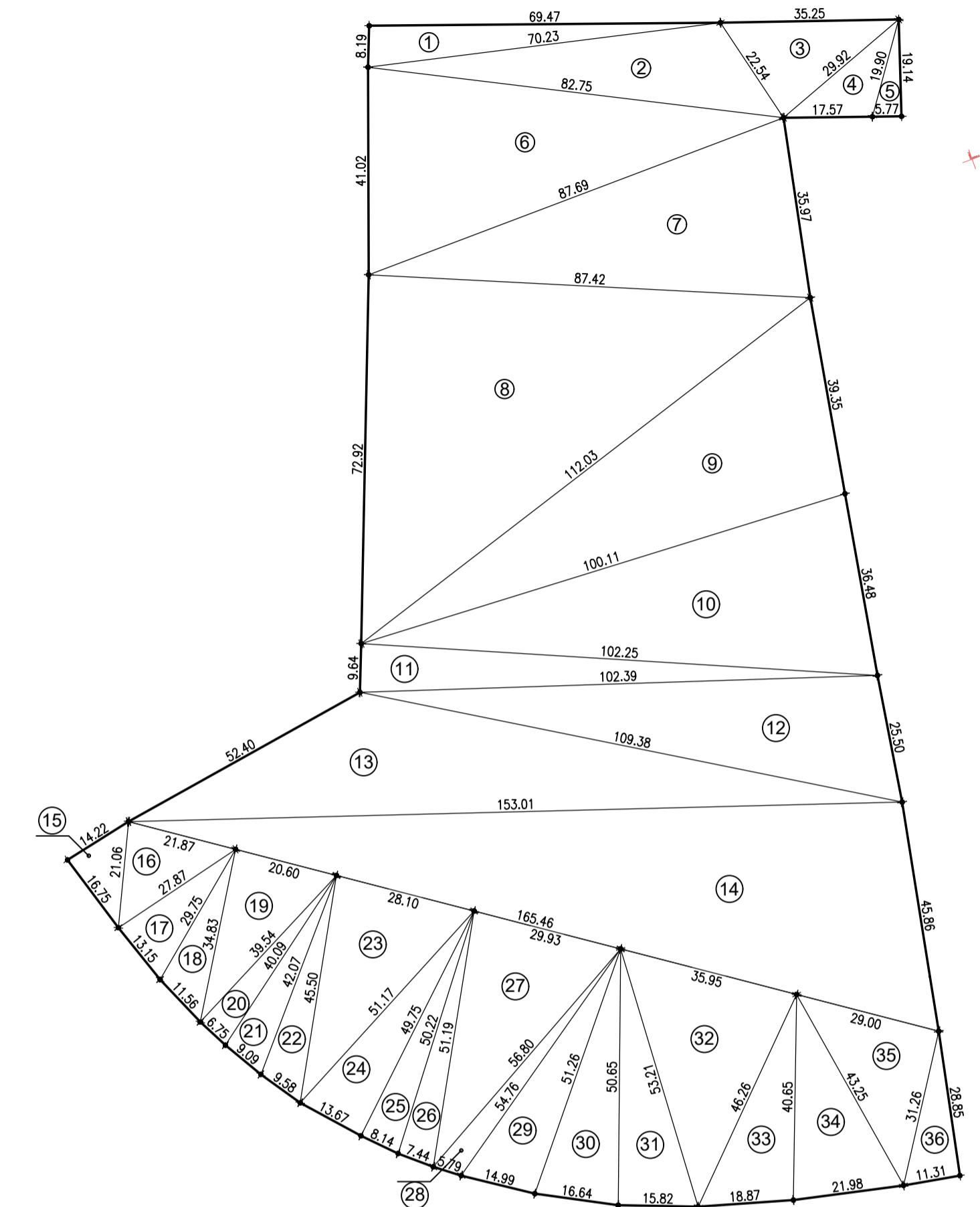

CALCOLO SUPERFICIE REALE scala 1:1000

TABELLA AREE SUPERFICI REALI

N.	MISURE	AREA
1	$\sqrt{73,95^2(73,95-8,19)^2(73,95-69,47)^2(73,95-70,23)}$	284,31
2	$\sqrt{87,76^2(87,76-70,23)^2(87,76-22,54)^2(87,76-82,75)}$	709,00
3	$\sqrt{43,86^2(43,86-35,25)^2(43,86-22,54)^2(43,86-29,92)}$	334,80
4	$\sqrt{33,70^2(33,70-29,92)^2(33,70-19,90)^2(33,70-17,57)}$	168,21
5	$\sqrt{22,41^2(22,41-19,90)^2(22,41-19,14)^2(22,41-5,77)}$	55,21
6	$\sqrt{105,73^2(105,73-82,75)^2(105,73-41,02)^2(105,73-87,69)}$	1684,14
7	$\sqrt{105,54^2(105,54-87,69)^2(105,54-87,42)^2(105,54-35,97)}$	1541,05
8	$\sqrt{136,19^2(136,19-87,42)^2(136,19-112,03)^2(136,19-72,92)}$	3185,69
9	$\sqrt{125,75^2(125,75-112,03)^2(125,75-100,11)^2(125,75-39,35)}$	1954,36
10	$\sqrt{119,42^2(119,42-100,11)^2(119,42-36,48)^2(119,42-102,25)}$	1812,16
11	$\sqrt{107,14^2(107,14-102,25)^2(107,14-102,39)^2(107,14-9,64)}$	492,58
12	$\sqrt{118,64^2(118,64-102,39)^2(118,64-25,50)^2(118,64-109,38)}$	1288,88
13	$\sqrt{157,40^2(157,40-109,38)^2(157,40-153,01)^2(157,40-52,40)}$	1865,32
14	$\sqrt{182,17^2(182,17-153,01)^2(182,17-45,86)^2(182,17-165,46)}$	3477,51
15	$\sqrt{26,02^2(26,02-14,22)^2(26,02-21,06)^2(26,02-16,75)}$	118,69
16	$\sqrt{35,40^2(35,40-21,06)^2(35,40-21,87)^2(35,40-27,87)}$	227,42
17	$\sqrt{35,39^2(35,39-27,87)^2(35,39-29,75)^2(35,39-13,15)}$	182,53
18	$\sqrt{38,07^2(38,07-29,75)^2(38,07-34,83)^2(38,07-11,56)}$	164,94
19	$\sqrt{47,49^2(47,49-34,83)^2(47,49-20,60)^2(47,49-39,54)}$	358,27
20	$\sqrt{43,19^2(43,19-39,54)^2(43,19-40,09)^2(43,19-6,75)}$	133,45
21	$\sqrt{45,63^2(45,63-40,09)^2(45,63-42,07)^2(45,63-9,09)}$	181,11
22	$\sqrt{48,58^2(48,58-42,07)^2(48,58-45,50)^2(48,58-9,58)}$	194,65
23	$\sqrt{62,39^2(62,39-45,50)^2(62,39-28,10)^2(62,39-51,17)}$	636,42
24	$\sqrt{57,30^2(57,30-51,17)^2(57,30-49,75)^2(57,30-13,67)}$	339,87
25	$\sqrt{54,06^2(54,06-49,75)^2(54,06-50,22)^2(54,06-8,14)}$	202,43
26	$\sqrt{54,43^2(54,43-50,22)^2(54,43-51,19)^2(54,43-7,44)}$	186,51
27	$\sqrt{68,96^2(68,96-51,19)^2(68,96-29,93)^2(68,96-56,80)}$	762,62
28	$\sqrt{58,68^2(58,68-56,80)^2(58,68-54,76)^2(58,68-5,79)}$	150,92
29	$\sqrt{60,51^2(60,51-54,76)^2(60,51-51,26)^2(60,51-14,99)}$	382,45
30	$\sqrt{59,28^2(59,28-51,26)^2(59,28-50,65)^2(59,28-16,64)}$	417,97
31	$\sqrt{59,84^2(59,84-50,65)^2(59,84-53,21)^2(59,84-15,82)}$	400,62
32	$\sqrt{67,71^2(67,71-53,21)^2(67,71-35,95)^2(67,71-46,26)}$	817,83
33	$\sqrt{52,89^2(52,89-46,26)^2(52,89-40,65)^2(52,89-18,87)}$	382,12
34	$\sqrt{52,94^2(52,94-40,65)^2(52,94-43,25)^2(52,94-21,98)}$	441,80
35	$\sqrt{51,76^2(51,76-43,25)^2(51,76-29,00)^2(51,76-31,26)}$	453,08
36	$\sqrt{35,71^2(35,71-31,26)^2(35,71-28,85)^2(35,71-11,31)}$	163,09
TOTALE		26152,02