

PROSPETTO LONGITUDINALE TRAVE Sc. 1:20

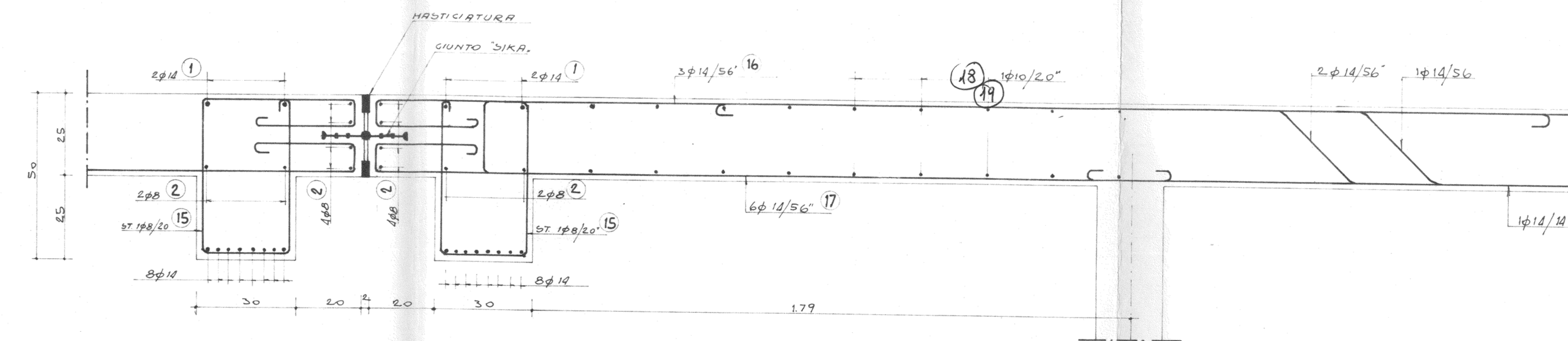

SEZIONE A-A' Sc. 1:10

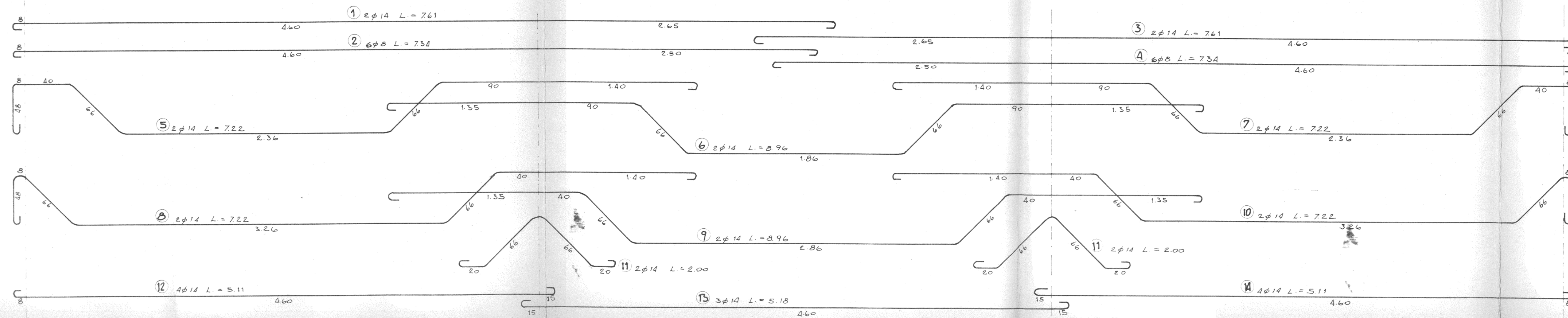
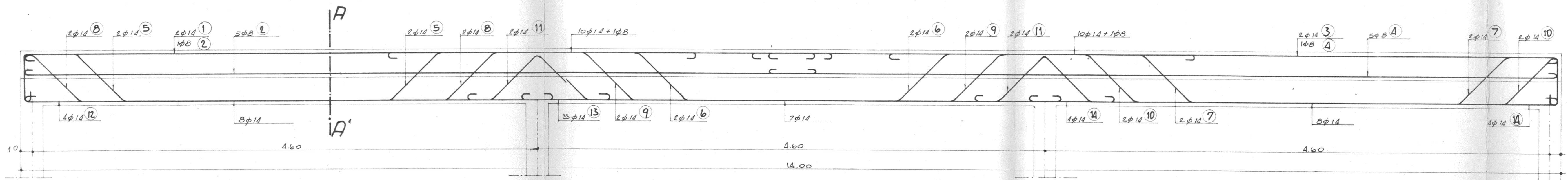
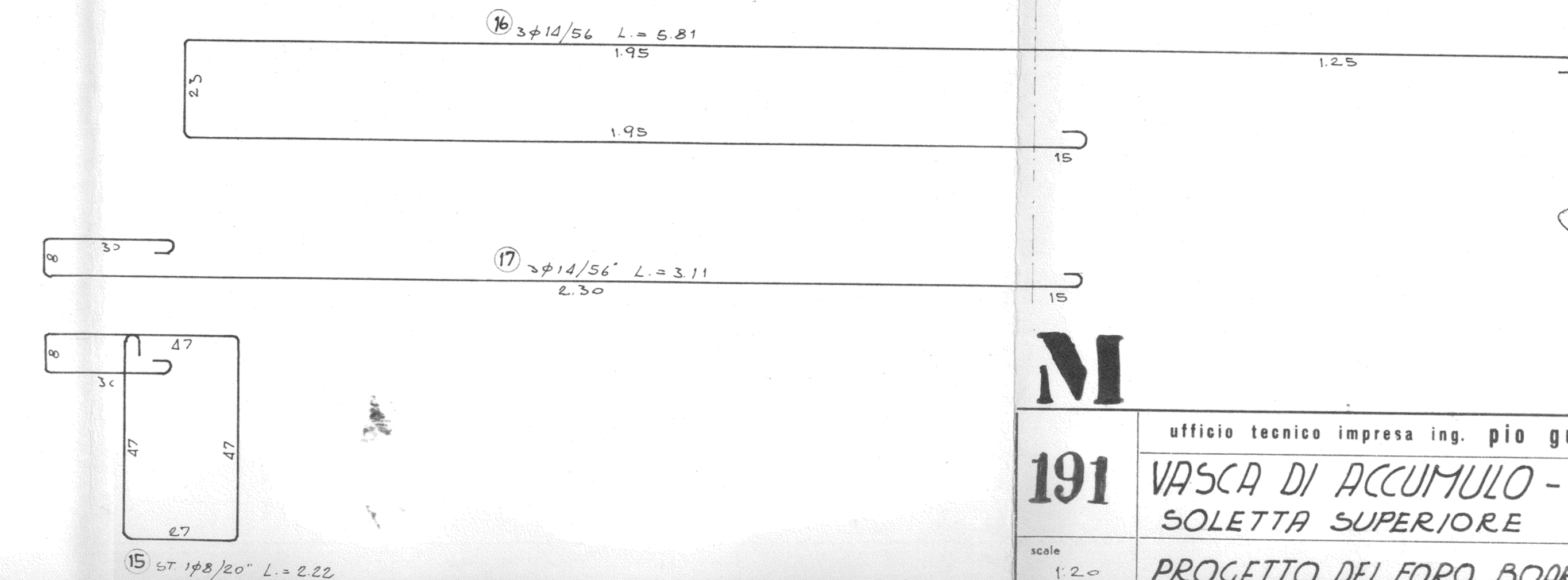

*[Signature]*  
Ing. PIO GUARALDO

**M**  
191  
ufficio tecnico impresa ing. pio guaraldo  
strada castellana  
paese - tv - (tel. 95111)

VASCA DI ACCUMULO - TRAVI DI GIUNTO  
SOLETTA SUPERIORE

PROGETTO DEL FORO BOARIO