

SEZIONE TRASVERSALE TIPO dc. 1:10

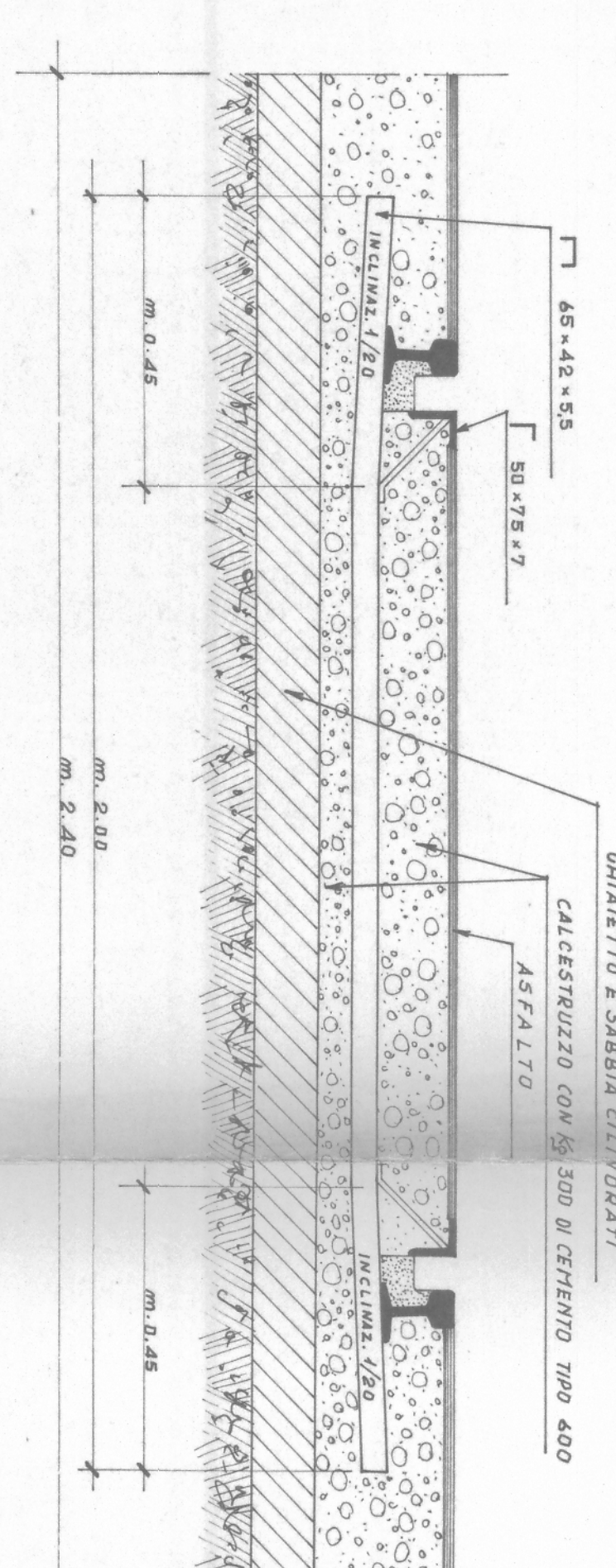

PARTICOLARE CONTROROTAIA E TRAVERSINI dc. 1:2

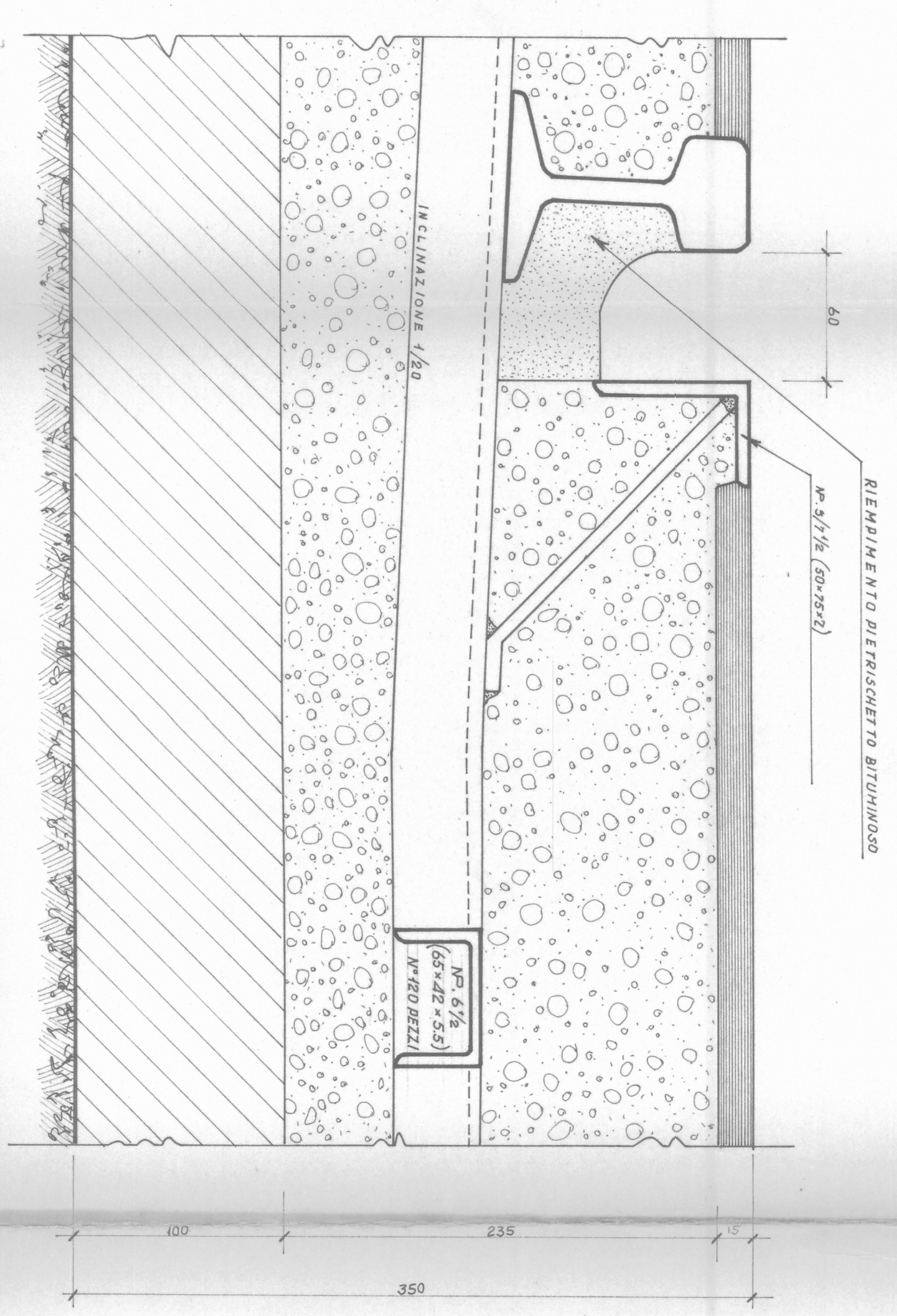

DISTRIBUZIONE TRAVERSINI dc. 1:100

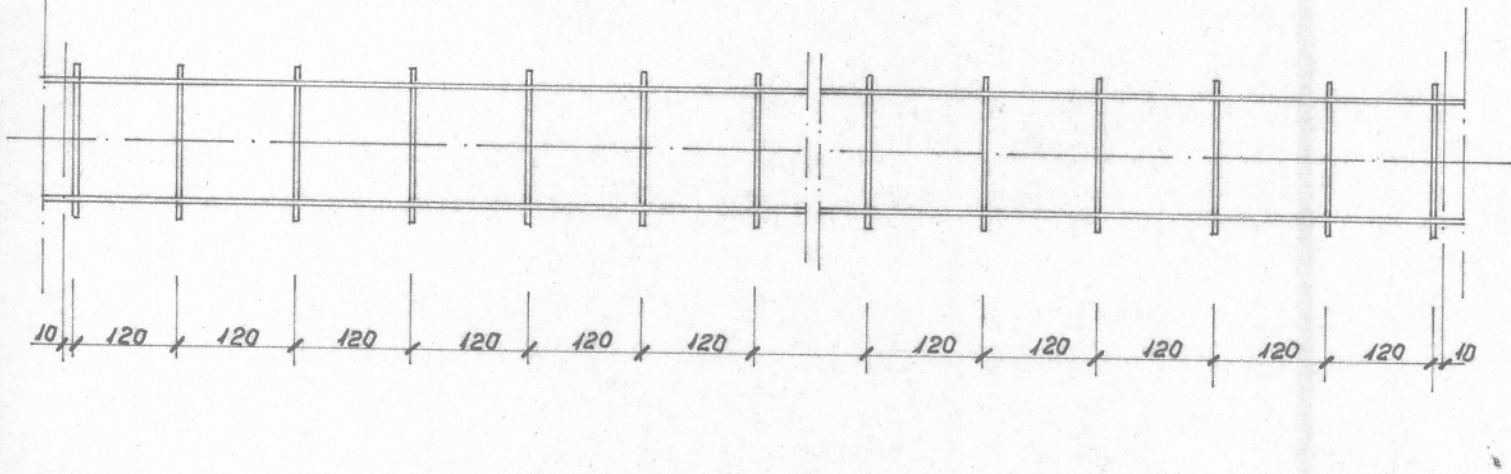

PARTICOLARE ROTIA ED ATTACCHI dc. 1:1

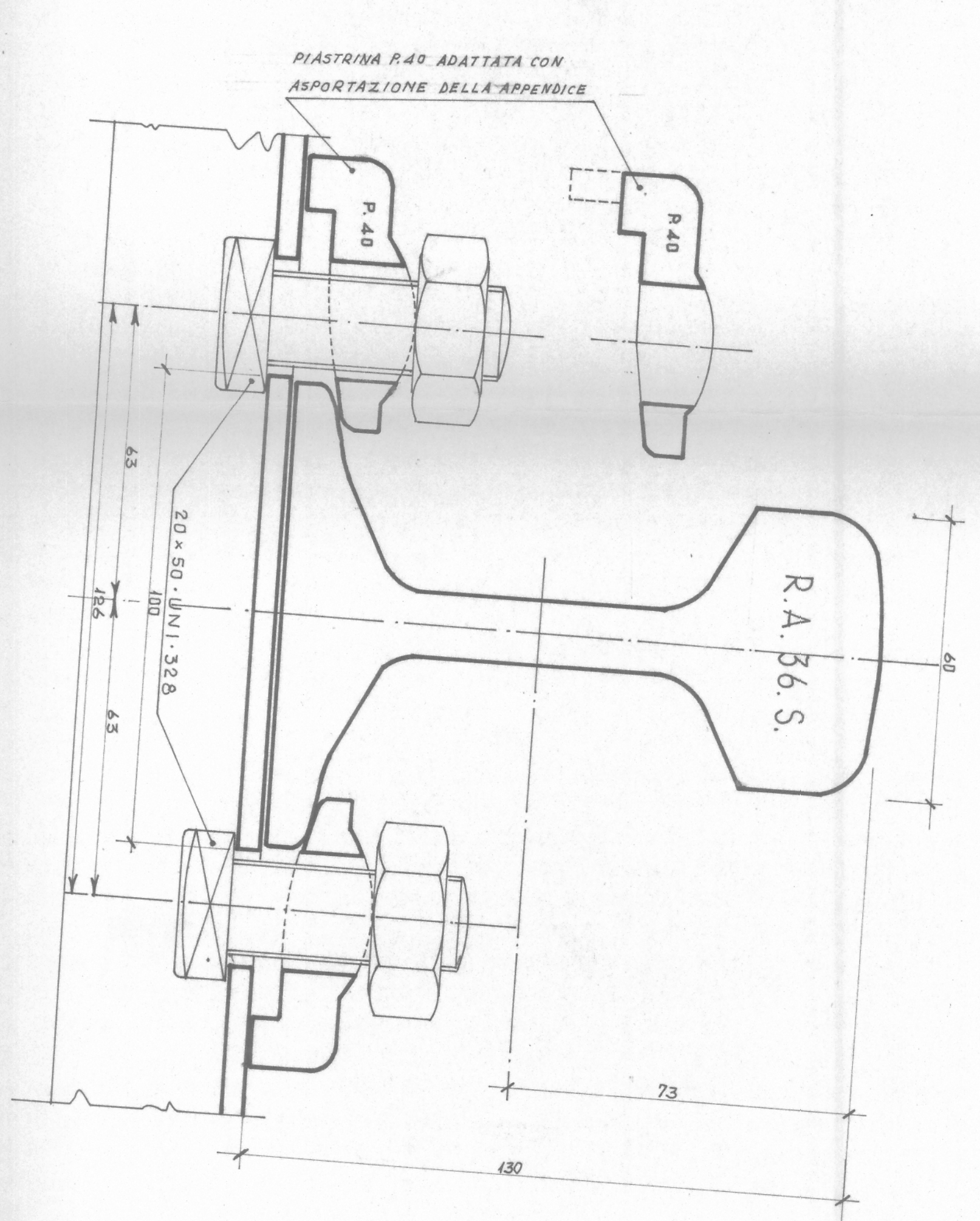

PARTICOLARE PARTE TERMINALE TRAVERSINI dc. 1:1

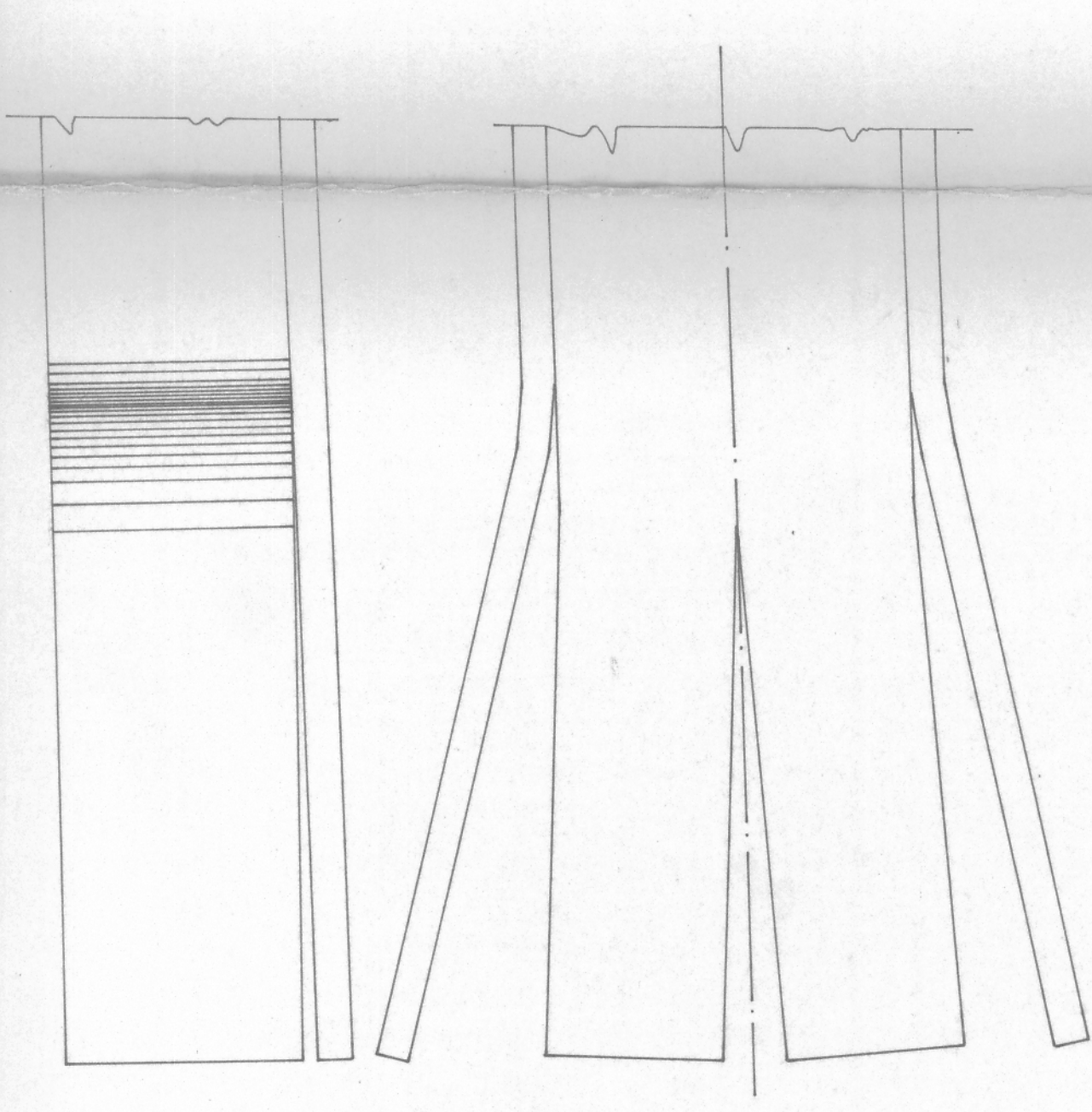

SEZIONE TRASVERSALE IN CORRISPONDENZA AL PIANO DI CARICO dc. 1:20

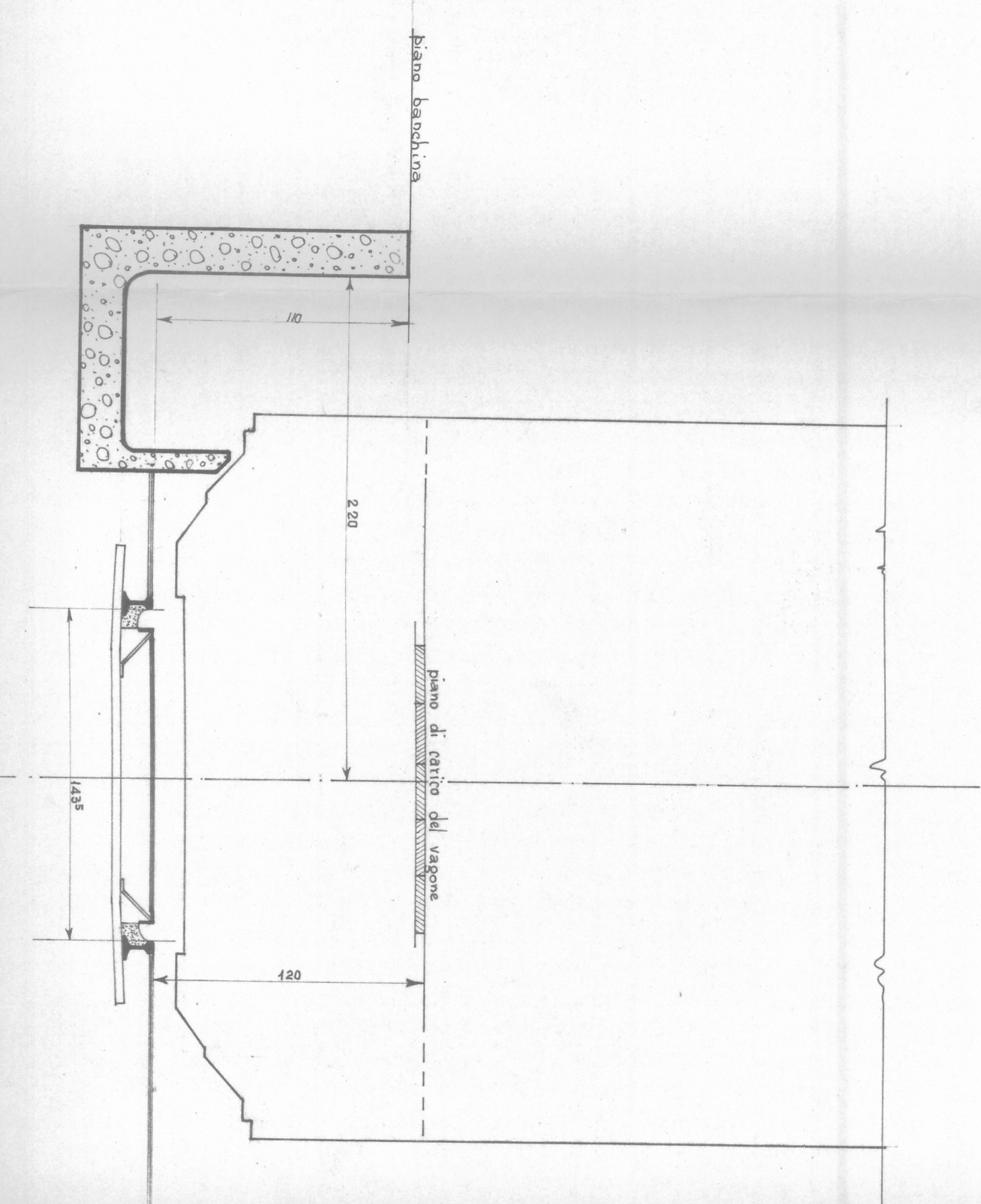

PROG.:	15/7/42
DATA:	15/7/42
PROGETTO:	DEL "FORD BOARD" DI DADOVA IN LOCALITÀ CHIESANUOVA
UFFICIO:	tecnico impresa ing. pio guaraldo
IND.:	stipoda castellano paese - IV - (tel. 47358)
PARTICOLARI RACCORDO FERROVIARIO	